

PART 1 - PLUMBING DEMOLITION PLAN

SCALE: 1/8" = 1'-0"



PLAN NOTES:

- 1 EXISTING PLUMBING FIXTURE(S) AND ALL ASSOCIATE WASTE, WATER, AND VENT PIPING TO REMAIN. PROTECT FIXTURES AND PIPING DURING CONSTRUCTION.
- 2 DISCONNECT AND REMOVE EXISTING PLUMBING FIXTURE AND ALL EXISTING WASTE, WATER AND VENT PIPING ASSOCIATED WITH FIXTURE. FIELD VERIFY EXACT SIZES AND LOCATIONS OF EXISTING PIPING. CAP LINE IN WALLS OR BELOW FLOOR WHERE NOT ACCESSIBLE. REFER TO ARCHITECTURAL DRAWINGS FOR PATCHING OF EXISTING WALLS AND FLOORS.
- 3 DISCONNECT AND REMOVE EXISTING PLUMBING FIXTURE. EXISTING WATER PIPING IN WALLS TO BE REMOVED WHERE ACCESSIBLE. (REFER TO LARGE SCALE PLANS ON SHEET P2.1 FOR NEW PIPING TO CONNECT TO EXISTING.) ADJUST EXISTING WASTE AND VENT PIPING AS REQUIRED TO CONNECT TO NEW FIXTURES. REFER TO SHEET P1.1 AND LARGE SCALE TOILET ROOMS ON SHEET P2.1 FOR NEW FIXTURES. FIELD VERIFY EXACT SIZES AND LOCATIONS OF EXISTING PIPING.
- 4 DISCONNECT AND REMOVE EXISTING FLOOR DRAIN AND P-TRAP. REFER TO SHEET P1.1 AND LARGE SCALE PLAN ON SHEET P2.1 FOR INSTALLATION OF NEW FLOOR DRAIN AND P-TRAP. CUT AND PATCH EXISTING CONCRETE FLOOR AS REQUIRED TO REPLACE DRAIN AND P-TRAP.
- 5 EXISTING WASTE PIPING IN AIR TUNNELS BELOW FLOOR TO REMAIN. PROTECT EXISTING PIPING DURING CONSTRUCTION. CONTRACTOR TO FIELD VERIFY EXACT SIZES AND ELEVATIONS OF EXISTING PIPING AND COORDINATE CONNECTION OF NEW PIPING TO EXISTING.
- 6 EXISTING 6" WASTE LINE BELOW GRADE TO REMAIN. CONTRACTOR TO FIELD VERIFY EXACT SIZE AND LOCATION OF EXISTING PIPING. RE-ROUTE EXISTING 6" LINE AS REQUIRED FOR NEW FOOTINGS. KEEP WASTE LINE 3'-0" (MINIMUM) AWAY FROM ANY PARALLEL FOOTING.
- 7 EXISTING ROOF DRAIN AND ROOF DRAIN PIPING IN CEILING SPACE TO REMAIN. CONTRACTOR TO FIELD VERIFY EXACT SIZES AND LOCATIONS. PROTECT PIPING AND DRAINS DURING CONSTRUCTION.
- 8 DISCONNECT EXISTING 8" ROOF DRAIN LINE AS IT EXITS THE BUILDING. ALL EXISTING DOWNSTREAM ROOF DRAIN PIPING TO BE RE-ROUTED AND REPLACED WITH NEW. REFER TO SHEET P1.2 FOR CONTINUATION OF NEW 8" ROOF DRAIN PIPING BELOW FLOOR. CONTRACTOR TO FIELD VERIFY EXACT SIZES AND ELEVATIONS. NEW PIPING TO MATCH SIZE AND ELEVATION OF EXISTING.
- 9 EXISTING ROOF TOP UNIT AND ALL ASSOCIATED PIPING TO REMAIN. FIELD VERIFY EXISTING CONDITIONS AND PROTECT PIPING AND EQUIPMENT DURING CONSTRUCTION.
- 10 OWNER TO DISCONNECT, REMOVE AND RE-INSTALL ALL EXISTING FIXTURES AND EQUIPMENT IN KITCHEN AREAS AS REQUIRED FOR NEW FLOOR FINISHES.

KEY PLAN

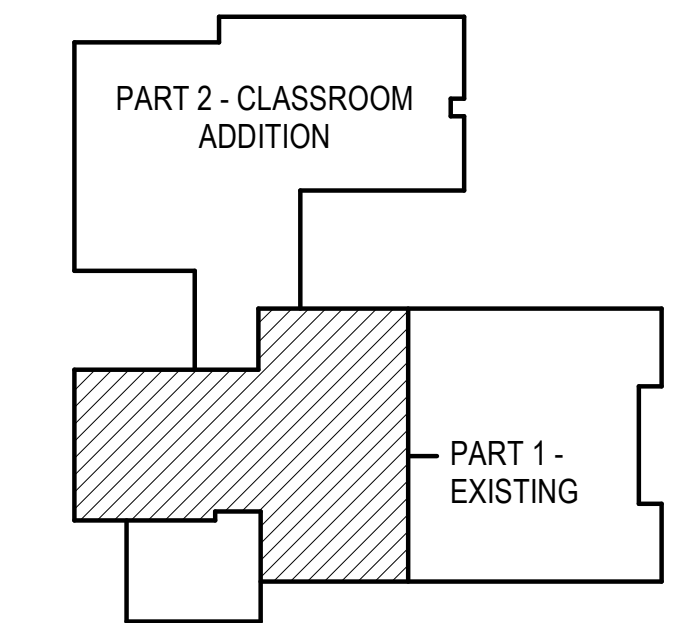

GENERAL NOTES:

- A- THE CONTRACTOR SHALL CHECK AND VERIFY ALL DIMENSIONS AND CONNECTIONS ON THE JOB SITE. ALL WORK SHALL BE EXECUTED FROM MEASUREMENTS TAKEN AT THE SITE.
- B- THE MECHANICAL CONTRACTOR SHALL BE RESPONSIBLE TO INSURE PROPER CODE CLEARANCES FOR ELECTRICAL AND MECHANICAL ACCESS WHEN INSTALLING ANY EQUIPMENT SUPPLIED BY THE MECHANICAL CONTRACTOR.
- C- IT IS CRITICAL THAT THIS CONTRACTOR COORDINATE EQUIPMENT LOCATIONS WITH PIPING, DUCTWORK, ELECTRICAL CONDUIT AND BUILDING STRUCTURE TO INSURE CODE COMPLIANCE.
- D- CEILING DIFFUSERS ARE SHOWN IN APPROXIMATE LOCATIONS. REFER TO LIGHTING PLANS AND REFLECTED CEILING PLAN FOR EXACT LOCATIONS.
- E- DUCT DIMENSIONS CALLED OUT ON DRAWINGS ARE INSIDE FREE AREA DIMENSIONS. ACOUSTICAL DUCT LINER ARE TO BE ADDED TO OVERALL MEASUREMENTS.
- F- ALL DUCTWORK AND PIPING WHICH PASSES THRU FIRE RATED WALLS TO BE FIRE STOPPED WITH APPROVED FOAM OR SEALANT. REFER TO SPECIFICATIONS FOR APPROVED MANUFACTURES.

ORIGINAL DRAWING SIGNED BY: DWAYNE C. SUDWEEKS
 DATE ORIGINAL SIGNED: April 12, 2018 ORIGINAL ON FILE AT:
 ENGINEERED SYSTEMS ASSOCIATES 1355 EAST CENTER,
 POCATELLO, IDAHO 83201

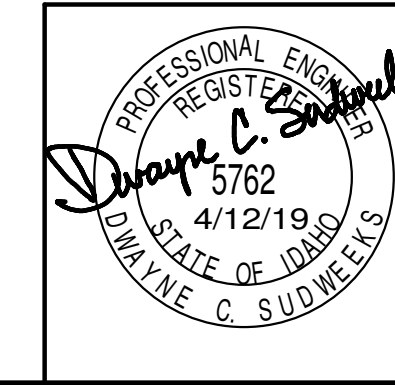

Engineered Systems Associates
 1355 EAST CENTER
 POCATELLO, IDAHO 83201
 PHONE: (208) 233-0501
 FAX: (208) 233-0529
 EMAIL: esa@engsystems.com
 ESA JOB NUMBER: 18072

PROJECT:
**ADDITION & REMODEL FOR:
 HARWOOD ELEMENTARY**
 JEFFERSON JOINT SCHOOL DISTRICT NO. 251
 200 W 3RD N, RIGBY, IDAHO 83442

PROJECT:

REVISIONS

NO.	DESCRIPTION

PROJECT NO.
16070
 DATE:
APRIL 2019
 DRAWN BY:
M JENSEN
 CHECKED BY:
D SUDWEEKS

DRAWING NO.:

P0.1

nbw architects.p.a.
 ARCHITECTURE / PLANNING / INTERIORS
 SCOTT L NELSON A.I.A. KEVIN R BODILY A.I.A. JAMES H WYATT A.I.A.
 990 JOHN RABAK PARKWAY P.O. BOX 2212 - IDAHO FALLS, IDAHO 83402-2212
 (208) 208-5322 (877) 208-5322 (208) 208-5322
 www.nbwarchitects.com

PART 1 - PLUMBING DEMOLITION PLAN

SHEET TITLE: